



Stadt Leipzig



STADT MARKKLEEBERG



Team Kunststoff

# 2019 ICF KANU-SLALOM WELTCUP

## KANUPARK MARKKLEEBERG

30.08.-01.09.



## Information Bulletin

WELCOME .....	3
GENERAL INFORMATION .....	4
Organisers .....	4
Keys contacts .....	4
Date .....	4
GENERAL INFORMATION ABOUT THE HOST CITY .....	5
LOCATION OF AIRPORTS, RAIL NETWORKS AND ROADS TO THE VENUE/CITY .....	6
ACCOMMODATION POSSIBILITIES.....	8
COMPETITION VENUE .....	9
TRAINING .....	12
Official training period .....	12
Training conditions outside this period .....	12
Training facilities near by .....	12
COMPETITION RULES.....	13
EVENTS.....	13
ENTRIES POLICIES.....	13
ACCREDITATION & PARTICIPATION FEE.....	13
Participation fee .....	13
Payment .....	13
ICF ONLINE ENTRIES & ACCREDITATION SYSTEM – SDP .....	14
PRINCIPLES.....	14
NOMINAL ENTRIES.....	14
REMINDER.....	14
EXTRA SERVICES.....	14
Team Catering .....	14
Medical Services.....	15
PRESS AND MEDIA INFORMATION .....	15
Services .....	15
PROVISIONAL COMPETITION SCHEDULE.....	16



## WELCOME

### to the World Cup of the world's best slalom canoeists



The city of Markkleeberg is happy and proud to host once again one of the ICF Canoe Slalom World Cups. From 30<sup>th</sup> of August to 1<sup>st</sup> of September 2019 the best paddlers from all over the world will ride a slalom course in Germany - in Markkleeberg. We will be glad to see many adrenalin filled races of speed and skill.

Only the best can tackle the tides, dodge the obstacles, and speed through up to 25 gates in a race against the clock. Therefore we expect many athletes, who won and competed in Olympic Games, World and European Championships.

200 athletes from 35 nations are glad to start once more in Markkleeberg and the German National team is always dedicated to enter the course of the 2015 European Championships especially due to the great audience at the home course and the exciting atmosphere.

The host "Leipziger-Kanu-Club" under the experienced guidance of Frithjof Bergner and Christoph Kirsten guarantees together with his long time approved staff an excellent organised event. Although it remains however again and again a great challenge to organize an ICF Canoe Slalom World Cup in Germany.

My first gratitude does not only apply to the mentioned persons but also particularly to more than 150 volunteers, who were committed to prepare best preconditions for the ICF Canoe Slalom World Cup Final in the last months and especially in last weeks.

Special thanks to the persons in charge of the City of Markkleeberg as well as to the patrons and sponsors, whose support makes this highlight finally possible.

I wish that all competitions of the Canoe Slalom World Cup will flow smoothly with good water and weather conditions. I keep my fingers crossed for all participants that they will be able to demonstrate their full power at this fourth of completely five Canoe Slalom World Cups once again.

GERMAN CANOE FEDERATION

Yours,

Thomas Konietzko  
President





## GENERAL INFORMATION

### Organisers

International Canoe Federation

German Canoe Federation

Leipziger-Kanu-Club e. V.

### Keys contacts

Leipziger-Kanu-Club e. V.  
c/o Kanupark Markkleeberg  
Wildwasserkehre 1  
044166 Markkleeberg  
Germany

Competition Manager      Christoph KIRSTEN      [office@slalomevents.de](mailto:office@slalomevents.de)  
+49/160/3654472

Technical Organiser      Christian FORMELLA      [info@slalomevents.de](mailto:info@slalomevents.de)

Event website:      [www.slalomevents.de](http://www.slalomevents.de)  
[www.canoeicf.com/canoe-slalom-world-cup/markkleeberg-2019](http://www.canoeicf.com/canoe-slalom-world-cup/markkleeberg-2019)

### Date

Access period:      26/08/19 - 01/09/19

Event period:      30/08/19 - 01/09/19



## GENERAL INFORMATION ABOUT THE HOST CITY

Kanupark Markkleeberg (venue) is situated in the South of city of Markkleeberg which is located in the Middle Eastern part of Germany and enclosed on the city of Leipzig. This region is one of the fastest growing areas in Germany. More than 2 Million inhabitants live within a radius of 50 km and more than 10 Million within a radius of 180 km (including cities like Berlin, Dresden, Erfurt, Halle, Potsdam, Magdeburg).

During the last 25 years the region around the city Leipzig has taken a turn from a coal mining area to a huge tourism area.

Among leisure activities like cycling, rollerblading, hiking, swimming or surfing the White Water attractions of Kanupark Markkleeberg are very popular.

These are the main facts about both the cities of...



	... Markkleeberg	... Leipzig
Area	32 km <sup>2</sup>	298 km <sup>2</sup>
Population	25.000	600.000
Mean annual temperature	13.5 °C	
Mean max. temperature August	23.9 °C	
Mean min. temperature August	13.3 °C	
Mean annual rainfall	43 mm	
Mean rainfall August	59 mm	

Especially the city of Leipzig is the economic, sportive and cultural heart of the Middle Eastern region of Germany. Companies like BMW, Porsche or DHL established factories during the last years. Additionally Leipzig Trade Fair is well known since many decades. Besides the business sector there is a huge cultural environment like the Orchestra of Gewandhaus Leipzig, the Thomaner Choir, Mädler Passage with "Auerbachs Keller" (J. W. v. Goethe "Faust") or facilities like the Opera and a wide range of theatres.

According to the historical development the city Leipzig was named the first time in 1015. In 1190 there was the first trade fair in Leipzig and during the last centuries Leipzig became one of the most important trading towns in Europe. The University of Leipzig was founded in 1409 and since 1990 many research institutes (e. g. Max-Planck-Institut, Fraunhofer-Institut, Helmholtz-Zentrum, Bio City) established in Leipzig. Even the German National Library is situated in Leipzig. Another historical key note is the victory of the Allied forces over Napoleon's army during the Battle of Nations in Leipzig in 1813. Furthermore in 1989 the peaceful revolution started at Nikolai Church Leipzig and more than 100.000 people demonstrated against the former regime of German Democratic Republic.

Besides these economic, cultural and historical key notes the development of sport is another very important constitution in Leipzig. The government of GDR has put a huge effort in developing several sport centers in Leipzig (especially in sports for the Olympic Summer Games). All the canoe slalom Gold medalists of the 1972 Olympic Games in Munich/Augsburg trained and lived in Leipzig and they are still connected to our sport. Also the inhabitants of Leipzig are keen on sports. During the bidding process for the Olympic Games 2012 nearly all people supported the candidature of Leipzig and at least Leipzig won the nationals bidding process against cities like Hamburg, Düsseldorf or Stuttgart.

## LOCATION OF AIRPORTS, RAIL NETWORKS AND ROADS TO THE VENUE/CITY

Kanupark Markkleeberg is situated next to **highway A38**. You can leave this highway in northward direction to City Markkleeberg and follow the main road B2. Leave main road B2 on first junction after approx. 3 km. Then follow the direction sign “Markkleeberger See” and “Kanupark”.



The distances to the major cities around the venue are...

Distance from...	...to Kanupark Markkleeberg	
Leipzig	10 km	20 min
Dresden	100 km	1 hour
Berlin	210 km	2 hours
Prague	250 km	2.5 hours
Frankfurt/Main	390 km	4 hours
Munich	430 km	4 hours
Augsburg	440 km	4 hours

All the main cities listed above (except Prague) can be reached via highways without any road charges or vignette. In addition all the named cities are very well accessible by trains.

Furthermore the cities of Leipzig and Markkleeberg are located next to the Leipzig-Halle Airport as well as connected to the national and European wide railway system.

The distances to the major transport hubs around the venue are...

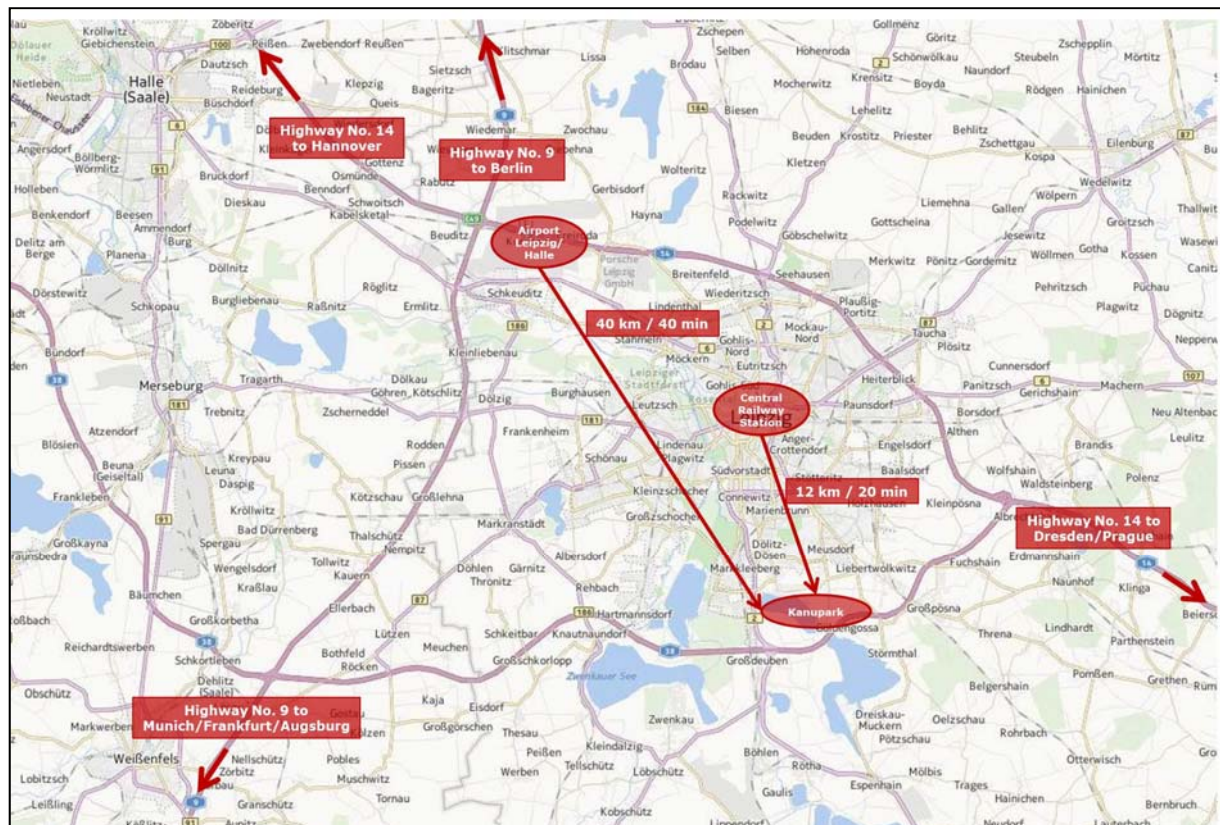

Distance from...	...to Kanupark Markkleeberg
Airport Leipzig/Halle (LEJ)	40 km / 40 min
Airport Berlin Schönefeld (SXF)	210 km / 2 h
Airport Frankfurt (FRA)	400 km / 4 h
Airport Munich (MUC)	420 km / 4 h
Exit highway No. 9 (Berlin - Munich/Frankfurt)	35 km / 20 min
Exit highway No. 14 (Hannover - Dresden)	12 km / 10 min
Exit highway No. 38 (Connection between highway No 9 and No. 14)	4 km / 5 min
Leipzig Central Railway Station	12 km / 20 min

## ACCOMMODATION POSSIBILITIES



The **Atlanta Hotel International Leipzig** supports this event and is the perfect place to accommodate athletes, coaches, officials and visitors. The hotel is situated near to the venue and reachable by car within a drive of 5 min. Next to the hotel is a big supermarket. You will find more information on [www.atlanta-hotel.de](http://www.atlanta-hotel.de).



Furthermore you will find **accommodations** next to the course on the following websites:

City Markkleeberg: [www.markkleeberg.de/de/kultur\\_tourismus/uebernachten](http://www.markkleeberg.de/de/kultur_tourismus/uebernachten)

City/region Leipzig: [www.leipzig.travel/en/Plan\\_your\\_stay/Accommodation\\_2057.html](http://www.leipzig.travel/en/Plan_your_stay/Accommodation_2057.html)



## COMPETITION VENUE

The course was built in 2006 and host of different national and international competitions during the last years. The course has a length of 270 m and a drop of 5.70 m. The amount of water will be 14 m<sup>3</sup>/s (white water level III-IV). For the competition we will fix the finish line approx. 40 m before the end of the course.

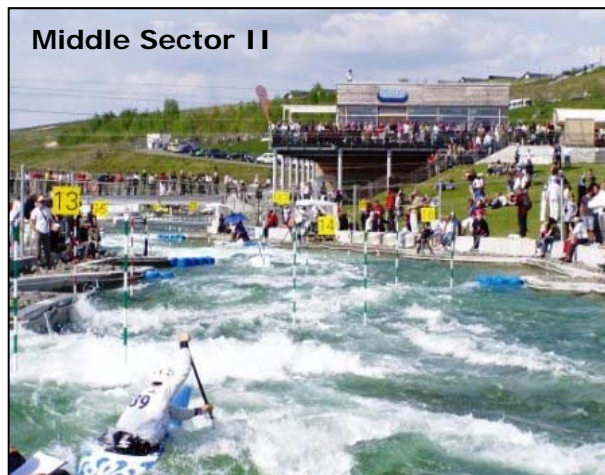



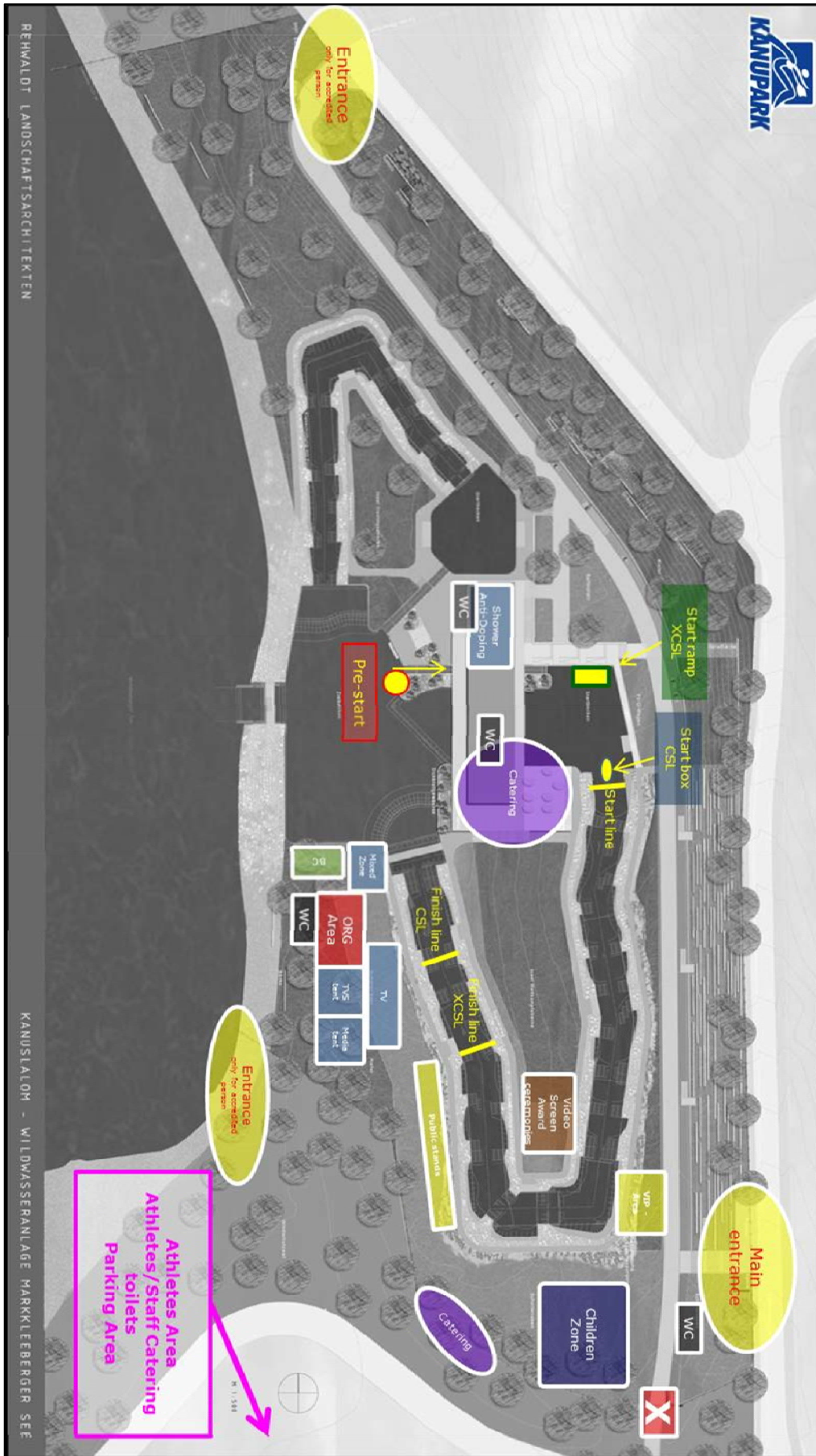

## TRAINING

### Official training period

The official training period is from Monday, 26/08/19 to Thursday, 29/08/19.

Training will be organised in groups according to schedule. The official training schedule will be published under: [www.canoeicf.com/canoe-slalom-world-cup/markkleeberg-2019](http://www.canoeicf.com/canoe-slalom-world-cup/markkleeberg-2019).

There will be one slot for each federation per day.

### Training conditions outside this period

Additional chargeable training sessions will be offered in the week before the official training period on the following days:

Tuesday	20/08/19	11:30 - 12:30 18:00 - 19:00	<b>Please note:</b>  <b>limited amount of boats</b>  with max. 30 boats	<u>costs per boat and session:</u>  <b>17.00 EUR</b>  (payable in cash on-site)
Wednesday	21/08/19	14:30 - 15:30		
Thursday	22/08/19	11:30 - 12:30 18:00 - 19:00		
Friday	23/08/19	11:30 - 12:30		
Saturday	24/08/19	08:30 - 09:30 19:30 - 20:30		
Sunday	25/08/19	09:30 - 09:30 18:30 - 19:30		

If you are interested in participation on these sessions or further sessions in July or August please send your request to [office@slalomevents.de](mailto:office@slalomevents.de).

### Training facilities near by

The distances to the training facilities around the venue are...

Distance from...	...to Kanupark Markkleeberg	
Prague	250 km	2.5 hours
Augsburg	440 km	4 hours

## COMPETITION RULES

2019 ICF Canoe Slalom World Cup and 2019 ICF Extreme Canoe Slalom World Cup will be run in accordance to the ICF Canoe Slalom Competition Rules.

## EVENTS

2019 ICF Canoe Slalom World Cup

MK1	Men's Kayak
MC1	Men's Canoe
WK1	Women's Kayak
WC1	Women's Canoe
XC2	Mixed's Canoe Double
MCSLX	Men's Extreme Canoe Slalom
WCSLX	Women's Extreme Canoe Slalom

## ENTRIES POLICIES

### Maximum boats:

ICF CSL 2019 World Cup (ICF Rules): maximum 3 boats per event

For Extreme Canoe Slalom 2 boats per NF in each category can be entered (only 1 boat per NF will advance from Time Trial phase, 2nd only if the capacity of next phase is not full). If you have any questions or problems concerning entries, please, do not hesitate to contact us or ICF.

## ACCREDITATION & PARTICIPATION FEE

Accreditation passes will be required to access the venue.

### Participation fee

**105,- €** per Athlete (Aa), Team Leader (AC), Technical Staff (Ao), Medical Staff (Am)

### Payment

Have to be made by **bank transfer** to the organiser's banking account **till 23/08/19**:

Bank: Sparkasse Leipzig  
 Account holder: Leipziger-Kanu-Club e.V.  
 BIC: WELADE8L  
 IBAN: DE28 8605 5592 1173 5282 09

For identifying your payment please use **2019\_ICF\_CSL\_WC\_IOC-Code**.

## ICF ONLINE ENTRIES & ACCREDITATION SYSTEM – SDP

### PRINCIPLES

Entries and accreditation requests must be made by the National Federation using the ICF's online entries system (SDP):

<https://icf.msl.es/icf/icf.jsp>

For detailed instructions on how to submit entries, please read the SDP user guide. Any questions or issues relating to entries or accreditation should be sent to [sdp@canoeicf.com](mailto:sdp@canoeicf.com) prior to the respective deadline.

SDP user guide [http://www.canoeicf.com/sites/default/files/nf\\_userguide\\_v2.2.pdf](http://www.canoeicf.com/sites/default/files/nf_userguide_v2.2.pdf)

### NOMINAL ENTRIES

Nominal entries close: **20/08/2019**

Each athlete competing must be entered by name.

Team personnel must also be submitted for accreditation at this time. These entries will be used to produce the accreditation cards for all teams.

### REMINDER

Entries or accreditation requests sent directly to the committee or the competition organiser will NOT be accepted.

## EXTRA SERVICES

### Team Catering

During the event period we offer the following dishes for lunch for the teams served in the catering tent in the Athletes Area:

<b>Friday, 30/08/19</b>	pasta with arrabiata sauce	pasta with spinach-cheese sauce
<b>Saturday, 31/08/19</b>	Vegetable rice with meatballs	Vegetable rice with quinoa burger
<b>Sunday 01/09/19</b>	Tortelloni with vegetable sauce	Tortelloni with tomato sauce

The costs per dish are 12,- EUR. Payment by bank transfer in advance is possible.

Orders can be made:

- by email: [office@slalomevents.de](mailto:office@slalomevents.de)

- till: **21/08/19**

## Medical Services

During the event period (30/08/19 to 01/09/19) we will provide a first aid service. Please note that this medical service will cover only emergency cases and that all participants are responsible to arrange, at their cost, their own medical insurance policy.

## Ticketing

During 2019 ICF Canoe Slalom World Cup Markkleeberg we will charge the following entrance fees:

	<b>Adults</b>	<b>Children</b> (10 - 18 years)	<b>Family</b> (2 adults + 2 children)
<b>Friday ticket</b> <b>30/08/19</b>	free entrance		
<b>Saturday ticket</b> <b>31/08/19</b>	10,- €	5,- €	21,- €
<b>Sunday ticket</b> <b>01/09/19</b>	10,- €	5,- €	21,- €
<b>Weekend ticket</b> <b>31/08 + 01/09/19</b>	17,- €	7,- €	38,- €

Children aged less than 10 years do not have to pay for entrance.

## PRESS AND MEDIA INFORMATION

### Services

To apply for a media accreditation, please complete the form under <https://www.canoeicf.com/canoe-slalom-world-cup/markkleeberg-2019/media>.

You will receive a confirmation email for submitting your application. A further confirmation email will be sent if your application is accepted, or an email from an ICF media representative to find out more about your media outlet. Please note that the ICF does not give any visa support letters.

All applicants requesting accreditation will be added to the ICF's media mailing list to receive ICF media releases. An unsubscribe option is available on each email.

The Media Area on-site is situated next to the finish line and the Officials Area.



## PROVISIONAL COMPETITION SCHEDULE

The current provisional competition schedule you can find here:

<https://www.canoeicf.com/canoe-slalom-world-cup/markkleeberg-2019/schedule>

